

COMPANY PROFILE



Mc'GIS  **KENYA**
GEOSYSTEMS

"Digital Geospatial Solutions"



2025

Leaders in Digital Geospatial Solutions



ABOUT US

McGIS KENYA GEOSYSTEMS LTD is a full-service provider of Digital Geospatial Solutions since 2014. We have since grown and established our niche in Aerial Surveys, Cadastral Surveys and due diligence, Topographical Surveys, Engineering Surveys, Photogrammetry, Digital Mapping, Geographic Information Systems (GIS), Remote Sensing (RS), Computer Aided Design (CAD), Spatial and Physical Planning, and Environmental Impact Assessment (EIA).

OUR VISION

Our Vision is to be the leading and most trusted provider of Geospatial and Digital Mapping solutions in Kenya.

OUR MISSION

Our Mission is to make a positive impact to the people of Kenya in whatever that we do and to proactively provide logical and actionable geospatial solutions.

OUR GOAL

Our Goal is to satisfy the geospatial needs of our clients and the country; and to promulgate sustainable development in

OUR CORE VALUES

We are **TRUE** to our course



Transparency



Rationality



Uniqueness



Excellence





OUR SOLUTIONS AND SERVICES

Today, Aerial Surveys employ the use of Unmanned Aerial Vehicles (UAVs) or drones due to their efficiency, flexibility, portability and operational incomplexity. On the other hand, photogrammetry involves obtaining accurate measurements and 3D spatial data from aerial imagery. Photogrammetry has a wide range of applications across industries with services and products such as Orthophoto generation, 3D modeling, Structural Inspection, Vegetation Monitoring, 3D Terrain Extraction, Stockpiles Volumetric Computation, Point Cloud Analysis, Urban Design and Simulation etc.

1. Construction and Infrastructure

- Site surveys and progress monitoring
- 3D modeling for design and planning
- Inspection of bridges, towers, and other structures

2. Agriculture

- Crop health monitoring & yield estimation
- 3D modeling for design and planning
- Inspection of built structures

3. Urban Planning and Development

- Spatial and Physical Planning
- Utility and asset data acquisition
- Urban morphology data acquisition

4. Surveying and Mapping

- Cadastral basemaps
- Terrain characterization
- Topographical mapping

5. Energy and Utilities

- Inspection of power lines, solar panels etc.
- Heat loss detection in power installations

6. Mining and Quarrying

- Stockpile volumetric computation
- Deformation monitoring

7. Environmental Monitoring

- Environmental Impact Assessment
- Habitat Monitoring and Analysis



Cadastral Surveys



Cadastral survey services involve defining, measuring, and mapping property boundaries and recording land ownership details. These surveys are essential for legal documentation, land development, and dispute resolution. We leverage on contemporary technology, including drones, GNSS, and GIS, thus making our delivery faster, accurate, fit-for-purpose, versatile and cost-effective.

We offer the following services and solutions:

1. New Grant Surveys

- Preparation of Part Development Plans
- Circulation for approvals and comments
- Establishment of controls and boundary beacons
- Approval of Survey Plans
- Processing of Title

2. Subdivision Surveys

- Preparation of a Subdivision Scheme Plan
- Circulation for approvals and comments
- Ground subdivision survey
- Registration of Survey and Title Processing

3. Boundary Re-establishment Surveys

- Extension of primary controls
- Staking out of corner beacons
- Establishment of concrete beacons
- Independent checking of corner beacons

4. Sectional Properties Survey

- Property georeferencing
- Statutory approvals and conversion
- Survey Authentication and Approval
- Processing of Sectional Titles

5. Conveyance & Due Diligence

- Title search and verification
- Ground and docs reconciliation
- Transfer of Title owner(s)
- Registration of New ownership

OUR SOLUTIONS AND SERVICES



Topographical Surveys



A topographical survey, often called a topo survey, is a detailed analysis of the natural and artificial features of a specific area of land. These surveys are crucial for projects involving construction planning, infrastructure development, environmental assessments, and urban planning. By mapping and observing spot heights thus contours and elevation, and surface features, topographical surveys provide essential data for various engineering and architectural projects.

OUR SOLUTIONS AND SERVICES

Engineering Surveys

Engineering survey services involve the application of precise measurement techniques to support the design, construction, and maintenance of infrastructure projects. These surveys provide critical data for roads, bridges, buildings, pipelines, and other civil engineering works, ensuring that projects are planned and executed accurately and efficiently. Survey works involve:-

- Orthometric Levelling
- Structural Vertical control
- Volumetric survey
- Structural setting out



Geographic Information Systems



Geographic Information Systems (GIS) services encompass the collection, analysis, visualization, and management of spatial data to support decision-making in various fields. By integrating geospatial and non-spatial data, GIS helps organizations efficiently analyze patterns and solve location-based challenges.

We offer the following services and solutions

1. Digital Mapping and Geovisualization

Creation of living interactive maps
Real-time visualization of spatial data
3D modeling of terrain and infrastructure

2. Spatial database Design and Development

Database architecture and engineering
Relational and NoSQL databases for GIS projects
Optimizing data management for large datasets

3. Asset and Facility Mapping and Management

Managing physical assets i.e. buildings, pipelines etc.
Maintenance and expansion planning
Asset and facility profiling

4. Geo- Analytics Services

Business intelligence and predictive analytics
Market analysis and client behavior insights
Spatial intelligence of specific phenomenon

5. Spatial Data Services

Fit-for-purpose data collection
Data cleaning, editing and manipulation
Data storage and maintenance

6. Technical Support and Training

Support on GIS solutions and software
Knowledge transfer on GIS techniques
Industry-specific training and support

**OUR
SOLUTIONS
AND
SERVICES**



Remote Sensing

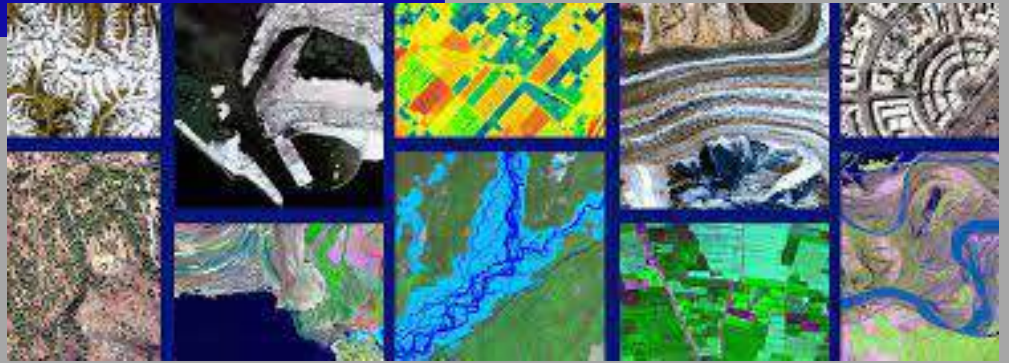

Remote sensing involves non-intrusive data collection using satellite or airborne sensors without physical interaction with the target. RS services and solutions play a crucial role in environmental monitoring, resource management, urban planning, and disaster mitigation.

OUR SOLUTIONS AND SERVICES

Remote Sensing

Our Solutions and Services involve:-

- Satellite Imagery procurement
- Advanced Spatial-temporal Analysis i.e. Change Detection
- Multispectral and Hyperspectral Imaging
- Resources Mapping and Monitoring
- Land Use and Land Cover (LULC) Mapping
- Big Data Integration and Deep Learning Solutions
- Fit-for-purpose RS applications
- Risk Assessment and Disaster Management
- Environmental and Ecosystems Monitoring
- Large Scale Topographical mapping
- Technical Training and Knowledge Transfer
- Large Scale Monitoring of spatial events/phenomena

Spatial & Physical Planning

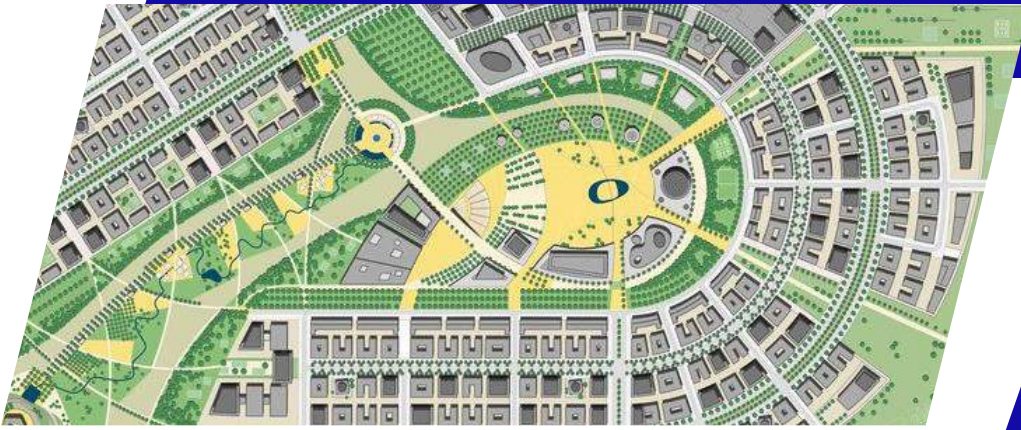

Spatial and Physical planning solutions are critical for the sustainable development and organization of urban and rural areas. These solutions encompass tools, strategies, and services aimed at optimizing land use, infrastructure, and environmental resources while addressing social, economic, and environmental challenges.

We offer the following services and solutions

1. Urban and Regional Planning

Land use allocation, zoning and development
Master planning to guide development

2. Land Use Optimization

Optimal land distribution within a scheme plan
Change of Use and Extension of Lease
Integrated environmental, social and economic planning

3. Environmental Impact Assessment

Project analysis and evaluation on environment
Sustainable development decision support

4. Infrastructure Planning

Strategic planning for transport and utilities
Layout and construction optimization

5. Climate Responsive Planning

Sustainable and Climate adaptive planning
Green and renewable systems planning

6. Housing and Real Estate Planning

Urban renewal and smart housing
Housing needs analysis & development

7. Urban Design and Simulation

Designing of urban morphology
Scenario planning and visualization

OUR SOLUTIONS AND SERVICES

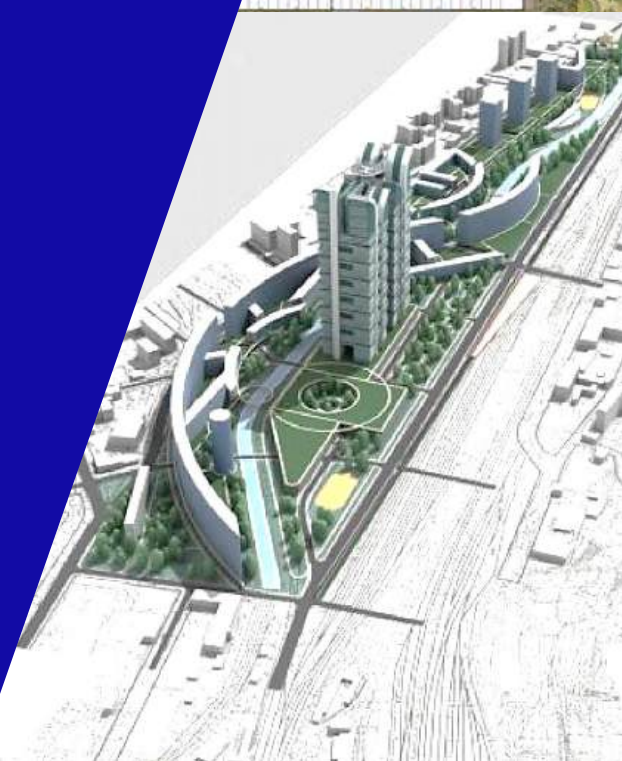

Projects & Assignments Portfolio



Project: Volumetric Survey of Salt Stockpiles and Damage Assessment of Structural Properties on LR. Nos. 22138, 21918 and 21983 (Approx. 10,000Acres) located North-East of Malindi town in Kilifi County - Kenya

KEMU SALT



Project: Aerial Topographical Survey of 250 Acres of land in Kiambu c/o Sasini Company, for the Purposes of Physical Planning and Sub-division into sub-plots of various areas.

EPITOME
SURVEYS LIMITED



Project: Cadastral Re-establishment Survey of LR No.209/9534 (Approx. 34.42Ha) located in Nairobi's South B Estate for Purposes of Spatial and Real Estate Planning as well as Asset base inventory.

KENYA RAILWAYS

Projects & Assignments Portfolio

Project: Aerial Topographical Survey of Olerai Primary School (Approx. 10Acres) located in Kiserian – Kajjado County, for purposes of facility management and location optimization of a new



Project: Aerial Survey, Spatial and Physical Planning, and cadastral survey for the purpose of squatter regularization on LR No. 8786 (Approx. 1400Acres) located in Athi River.



Project: Engineering survey involving control of levels during cuts and back fills as well as stockpile and compressed volume computations for Phase 2 of silos development in Syokimau.



Project: Topographical Survey, Physical Planning and Subdivision of Kasiti Estate; LR No. 11486 (Approx. 1000Acres) located along the Gatanga Rd. – Muranga County.



Project: Topographical, Title Survey and Fixation of the Thuci to Nkubu; Meru to Maua; and Londiani to Fort Ternan Road Reserve and the development of spatial database of acquisitions.



Project: Cadastral Subdivision Survey of Mavoko Town Block 3 | 15721 into nineteen (19) portions of various areas and processing of sub-plot Titles; Malaa – Machakos County.



Project: Cadastral due diligence involving – data acquisition, parcel identification, boundary re-establishment, & site location plans of properties in Nairobi and Mavoko.



Project: Topographical Survey, Digital Mapping and 3D Terrain simulation of the Proposed Recreational Park (Approx. 25Acres) located in Embu Town.



Project: Topographical and boundary re-establishment Survey of various parcels across 25 Counties for the purpose of structural development for schools.



Project: Cadastral Boundary Re-establishment for Yare Business Park (LR No.36/VII/1028 – Approx. 2.045Ha) located in Nairobi's Eastleigh Estate along General Waruingi Street



Projects & Assignments Portfolio

Project: New Grant Survey, Subdivision into blocks, Physical Planning and Land Use Optimization of 28,000 Acres located North-East of Isiolo Township.



Project: Aerial Topographical Survey of 5000 Acres of land for surface drainage analysis and establishment of the proposed water reservoir in Makindu – Makueni County.



Consortium Pool



HIGHLAND SURVEYORS
Quality mapping solutions

GCL | **GEORALVIN CONSULT LTD**
'Transforming Spaces, Enriching Lives'



JP
Advocates
LLP



KEVIN & ASSOCIATES LLP™

M
MULANYA & MAONDO
ADVOCATES



F
Futures Net
— Today's Tomorrow —



Finix Consulting Ltd
Consulting Engineers



m&r
Consult

A
avado

INDEX-AFRICA LIMITED

REGISTERED VALUERS, PROJECT APPRAISERS, ESTATE MANAGING AGENTS, LAND CONSULTANTS



Get in Touch

Mc'GIS Kenya Geosystems Limited
3rd Floor, Suite 303, Madonna House
Mpaka Road – Off Westlands Road
P.O. Box 9562 – 00100, Nairobi Kenya
Tel: +254724968929
Email: info@mcgiskenya.co.ke
Website: www.mcgiskenya.co.ke

